



ABSORBEDOR – CH ABS

CH ABS

FICHA TÉCNICA

Producto



Descripción

- Componente de la línea de vida CHECKLINE OVERHEAD
- Su principal misión es absorber la energía producida por una caída reduciendo la tensión en los extremos.

Norma

EN 795 Tipo C

CARACTERÍSTICAS

Características generales

Referencia	200701500014
Material	Acero Inox 304
Peso	2,95 kg
Dimensiones	610xø64 mm

PLANOS

Conjunto

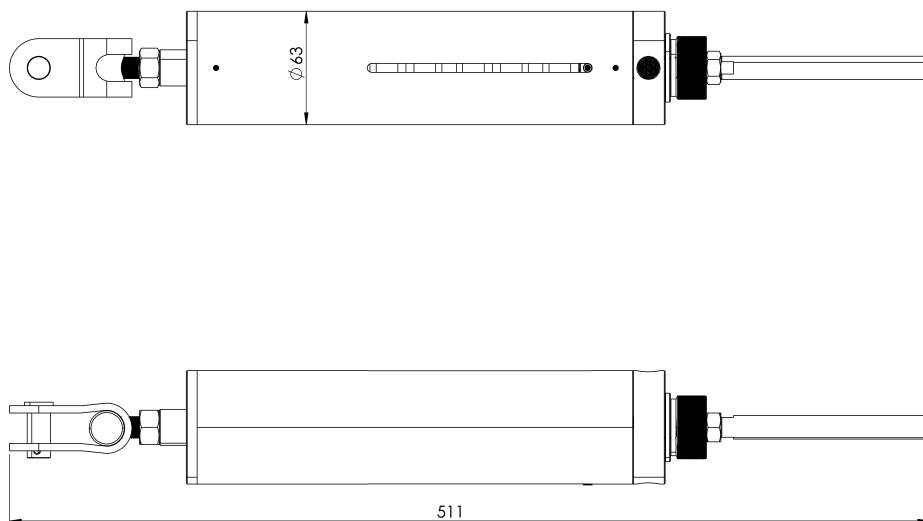

CH ABS

Product



Description

- Lifeline component CHECKLINE OVERHEAD
- Its main task is to absorb the energy produced by a fall by reducing the voltage at the ends.

Standard

EN 795 Type C

CHARACTERISTICS

General characteristics

Reference	200701500014
Material	304 stainless steel
Weight	2,95 kg
Dimensions	610xø64 mm

PLANS

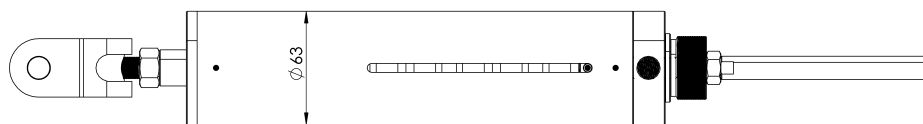
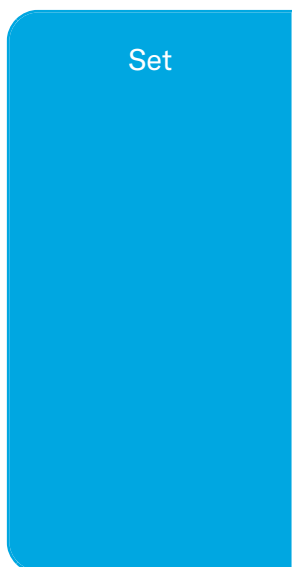

CH ABS

Prodotto



Descrizione

- Componente della linea di vita CHECKLINE OVERHEAD
- Il suo compito principale è quello di assorbire l'energia prodotta da una caduta riducendo la tensione alle estremità.

Standard

EN 795 Tipo C

CARATTERISTICHE

Caratteristiche generali

Riferimento	200701500014
Materiale	Acciaio inox 304
Peso	2,95 kg
Dimensioni	610xø64 mm

PIANI

Set

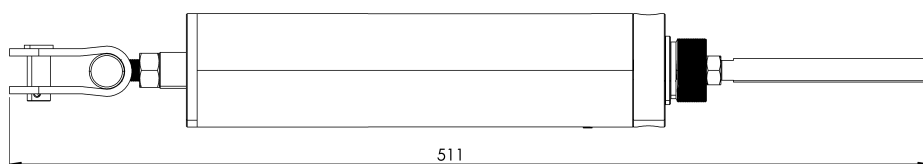
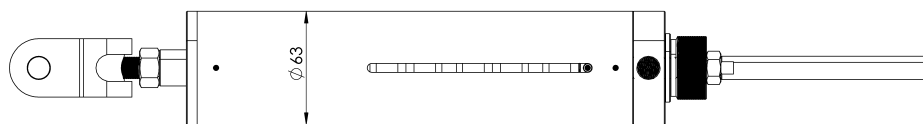

CH ABS

Produto



Descrição

- Componente da linha de vida CHECKLINE OVERHEAD
- A sua principal função é absorver a energia produzida por uma queda, reduzindo a tensão nas extremidades.

Padrão

EN 795 Tipo C

CARACTERÍSTICAS

Caraterísticas gerais

Referência	200701500014
Material	Aço inoxidável 304
Peso	2,95 kg
Dimensões	610xø64 mm

PLANOS

Conjunto

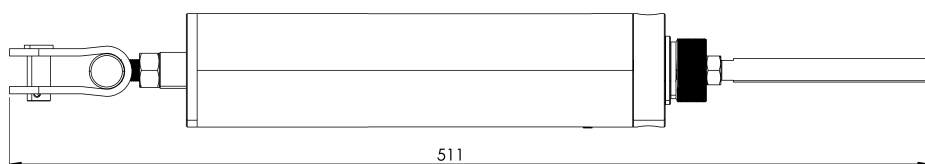
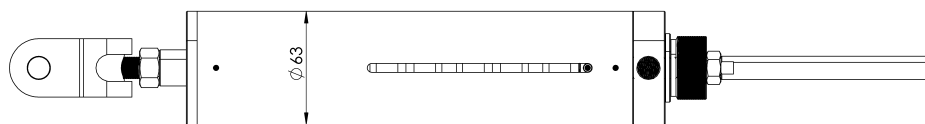

CH ABS

Produit



Description

- Composant de la ligne de vie CHECKLINE OVERHEAD
- Sa tâche principale est d'absorber l'énergie produite par une chute en réduisant la tension aux extrémités.

Standard

EN 795 Type C

CARACTÉRISTIQUES

Caractéristiques générales

Référence	200701500014
Matériel	Acier inoxydable 304
Poids	2,95 kg
Dimensions	610xø64 mm

PLANS

Set (jeu de mots)

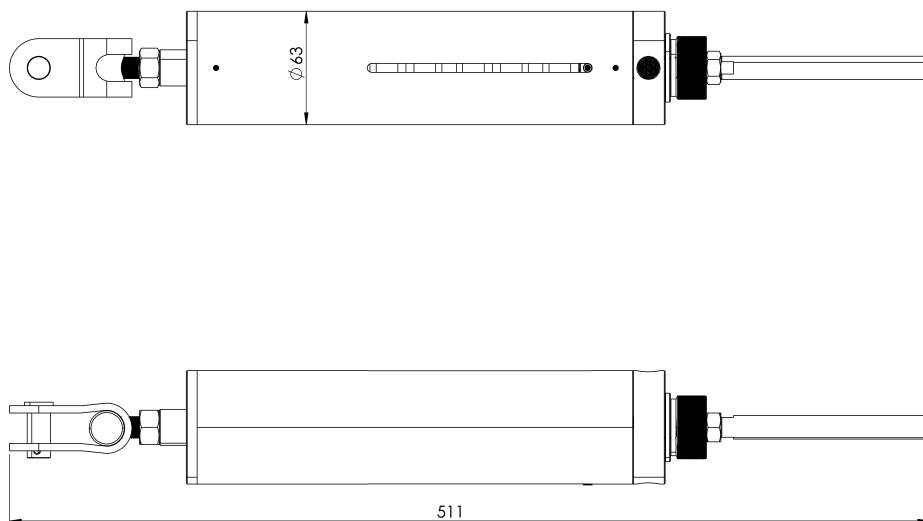

CH ABS

Produkt



Beschreibung

- Lifeline-Komponente CHECKLINE OVERHEAD
- Seine Hauptaufgabe besteht darin, die bei einem Sturz entstehende Energie zu absorbieren, indem die Spannung an den Enden reduziert wird.

Standard

EN 795 Typ C

EIGENSCHAFTEN

Allgemeine Merkmale

Referenz	200701500014
Material	Rostfreier Stahl 304
Gewicht	2,95 kg
Abmessungen	610xø64 mm

PLANEN

Einstellung

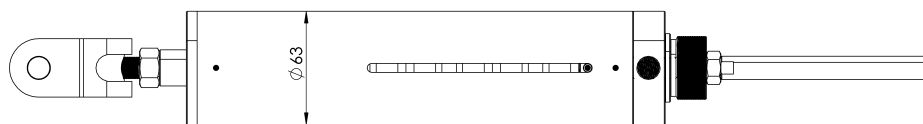

CH ABS

Produkt



Opis

- Element linii życia CHECKLINE OVERHEAD
- Jego głównym zadaniem jest pochłanianie energii wytwarzanej przez upadek poprzez zmniejszenie napięcia na końcach.

Standard

EN 795 Typ C

CHARAKTERYSTYKA

Ogólna charakterystyka

Odniesienie	200701500014
Material	Stal nierdzewna 304
Waga	2,95 kg
Wymiary	610xø64 mm

PLANY

Zestaw

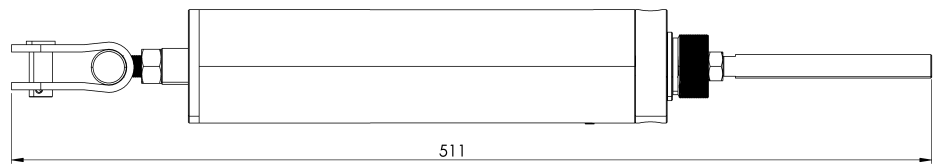
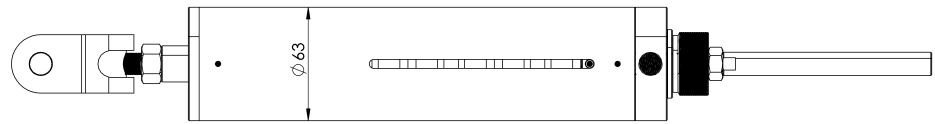

CH ABS

Termék



Leírás

- Életvonal-összetevő CHECKLINE OVERHEAD
- Fő feladata, hogy a végeken a feszültség csökkentésével elnyelje az esés által termelt energiát.

Standard

EN 795 C típus

JELLEMZŐK

Általános jellemzők	Hivatkozás	200701500014
	Anyag	304 rozsdamentes acél
	Súly	2,95 kg
	Méret	610xø64 mm

TERVEK

Állítsa be a

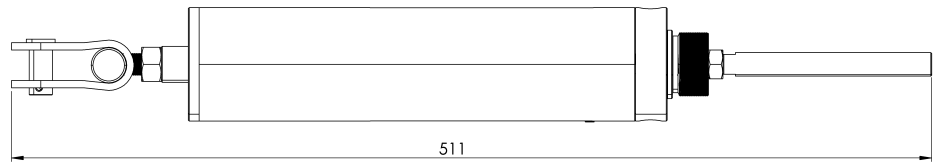
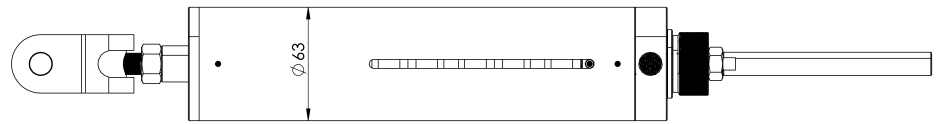

CH ABS

Produto



Descrição

- Componente da linha de vida CHECKLINE OVERHEAD
- Sua principal tarefa é absorver a energia produzida por uma queda, reduzindo a tensão nas extremidades.

Padrão

EN 795 Tipo C

CARACTERÍSTICAS

Características gerais

Referência	200701500014
Material	Aço inoxidável 304
Peso	2,95 kg
Dimensões	610xø64 mm

PLANOS

Conjunto

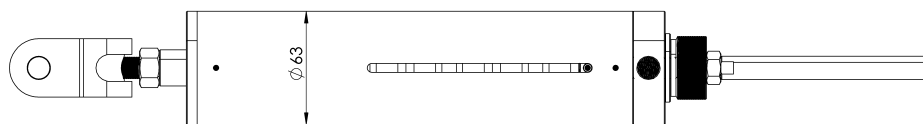

CH ABS

Продукт



Описание

- Компонент на спасителната линия CHECKLINE OVERHEAD
- Основната му задача е да абсорбира енергията, получена при падане, като намалява напрежението в краищата.

Стандартен

EN 795 Тип C

ХАРАКТЕРИСТИКИ

Общи характеристики

Справка	200701500014
Материал	304 неръждаема стомана
Тегло	2,95 кг
Размери	610xø64 mm

ПЛАНОВЕ

Задайте

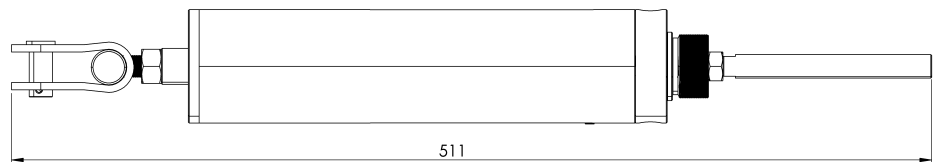
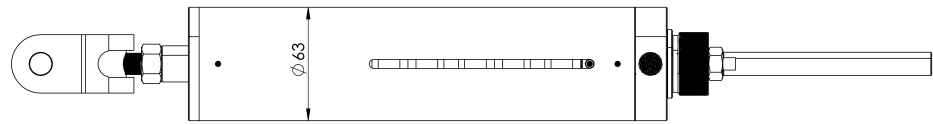

CH ABS

Produkt



Beskrivning

- Lifeline-komponent CHECKLINE OVERHEAD
- Dess huvuduppgift är att absorbera den energi som uppstår vid ett fall genom att minska spänningen i ändarna.

Standard

EN 795 Typ C

EGENSKAPER

Allmänna egenskaper

Reference (referens)	200701500014
Material	304 rostfritt stål
Vikt	2,95 kg
Dimensioner	610xø64 mm

PLANER

Ställ in

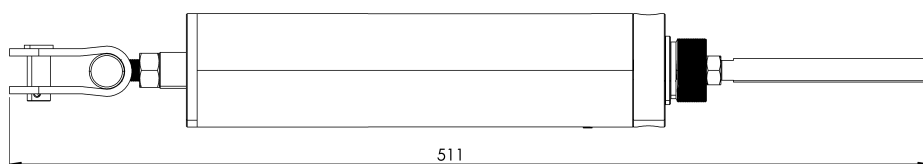
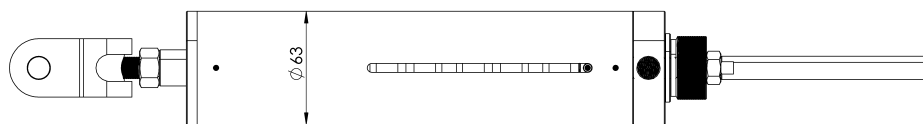

CH ABS

Produkt



Popis

- Komponent Lifeline CHECKLINE OVERHEAD
- Jeho hlavnou úlohou je absorbovať energiu vzniknutú pri páde znížením napätia na koncoch.

Štandard

EN 795 Typ C

CHARAKTERISTIKA

Všeobecná charakteristika

Referencia	200701500014
Materiál	304 nehrdzavejúca oceľ
Hmotnosť	2,95 kg
Rozmery	610xø64 mm

PLÁNY

Nastavenie

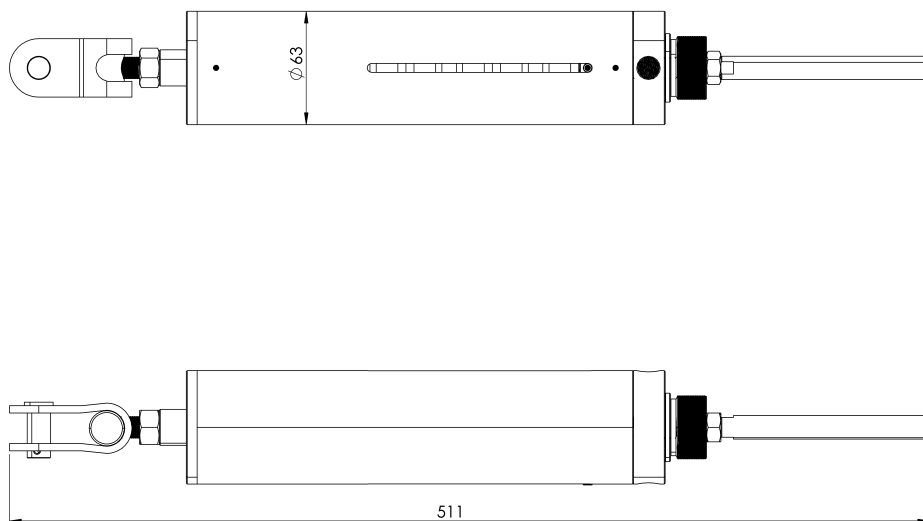

CH ABS

Produktas



Aprašymas

- Gelbėjimo linijos komponentas CHECKLINE OVERHEAD
- Pagrindinė jo užduotis - absorbuoti kritimo metu susidariusią energiją sumažinant įtampą galuose.

Standartinis

EN 795 C tipas

CHARAKTERISTIKOS

Bendrosios savybės	Nurodymai	200701500014
	Medžiaga	304 nerūdijantis plienas
	Svoris	2,95 kg
	Matmenys	610xø64 mm

PLANAI

Nustatyti

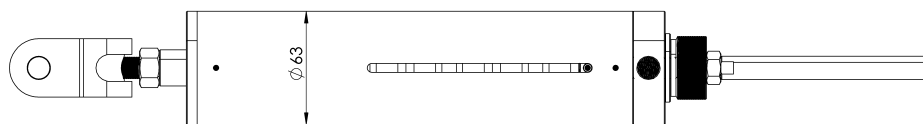

CH ABS

Produkt



Beskrivelse

- Lifeline-komponent CHECKLINE OVERHEAD
- Hovedoppgaven er å absorbere energien fra et fall ved å redusere spenningen i endene.

Standard

EN 795 Type C

EGENSKAPER

Generelle egenskaper

Referanse	200701500014
Materiale	304 rustfritt stål
Vekt	2,95 kg
Dimensjoner	610xø64 mm

PLANER

Sett

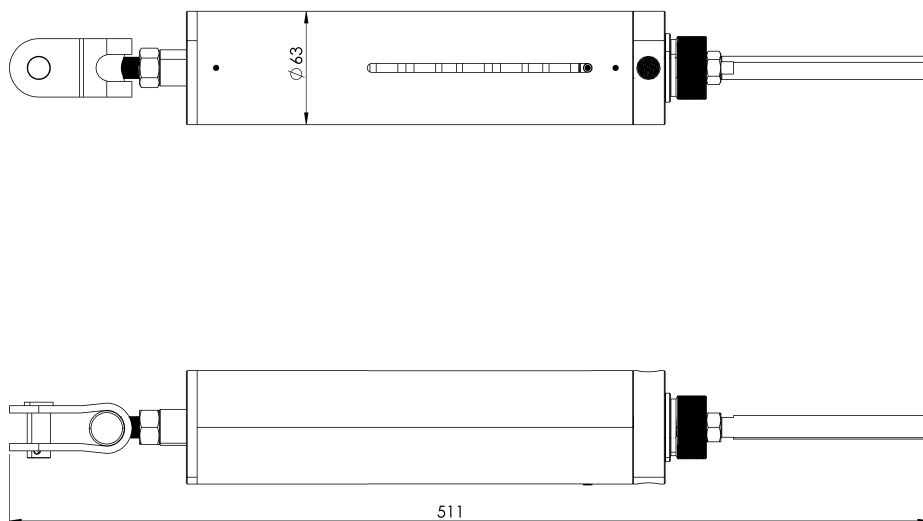

CH ABS

Produs



Descriere

- Componenta Lifeline CHECKLINE OVERHEAD
- Sarcina sa principală este de a absorbi energia produsă de o cădere prin reducerea tensiunii la capete.

Standard

EN 795 Tip C

CARACTERISTICI

Caracteristici generale

Referință	200701500014
Material	304 oțel inoxidabil
Greutate	2,95 kg
Dimensiuni	610xø64 mm

PLANURI

Set

