



**PIEZA  
INTERMEDIA  
OVERHEAD  
- CHO INTER**

# CHO INTER

FICHA TÉCNICA

## Producto



## Descripción

- Componente de la línea de vida CHECKLINE OVERHEAD
- Su principal misión es ser el apoyo intermedio del cable.
- Puede ser colocado con una distancia máxima de 12m entre si.
- Están diseñados específicamente para que los CARROS OVERHEAD pudiesen superar con facilidad la pieza, sin desconectarse de la línea de vida.

## Norma

EN 795 Tipo C

## CARACTERÍSTICAS

### Características generales

Referencia	200701500030
Material	Acero Inox 304
Peso	1,15 Kg
Dimensiones	155x98 mm

# PLANOS

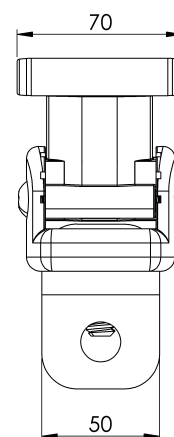
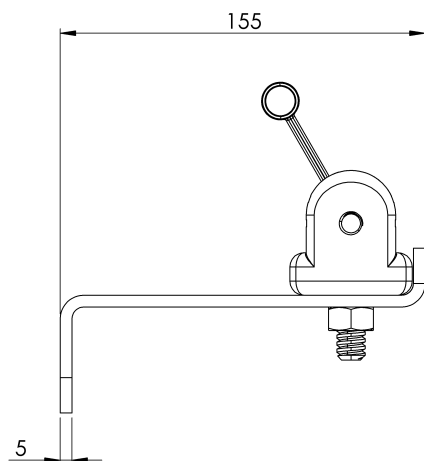
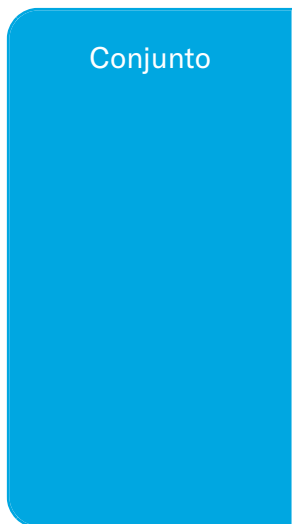

# CHO INTER

## Product



## Description

- Lifeline component CHECKLINE OVERHEAD
- Its main mission is to be the intermediate support for the cable.
- It can be placed at a maximum distance of 12m from each other.
- They are specifically designed so that the OVERHEAD CARTS could easily overcome the part, without disconnecting from the lifeline.

## Standard

EN 795 Type C

# CHARACTERISTICS

## General characteristics

Reference	200701500030
Material	304 stainless steel
Weight	1,15 Kg
Dimensions	155x98 mm

# PLANS

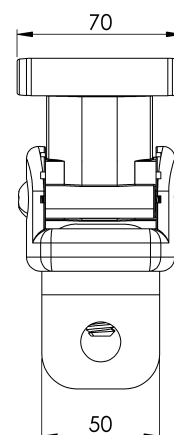
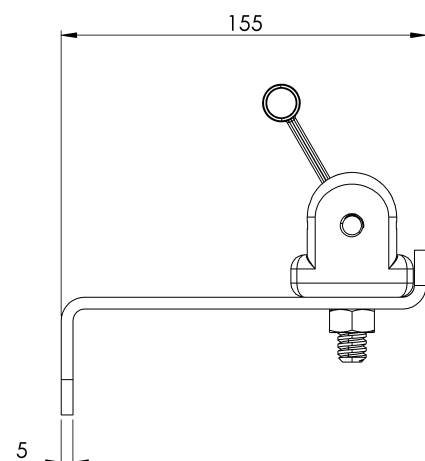
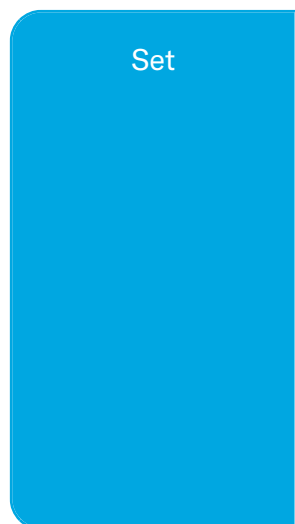

# CHO INTER

## Prodotto



## Descrizione

- Componente della linea di vita CHECKLINE OVERHEAD
- La sua missione principale è quella di essere il supporto intermedio del cavo.
- Possono essere collocati a una distanza massima di 12 m l'uno dall'altro.
- Sono stati progettati specificamente in modo che i carrelli elevatori possano superare facilmente la parte, senza staccarsi dalla linea di vita.

## Standard

EN 795 Tipo C

# CARATTERISTICHE

## Caratteristiche generali

Riferimento	200701500030
Materiale	Acciaio inox 304
Peso	1,15 Kg
Dimensioni	155x98 mm

# PIANI

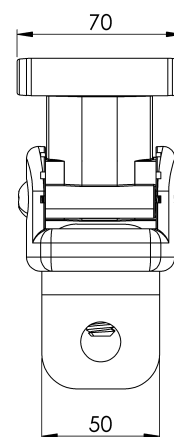
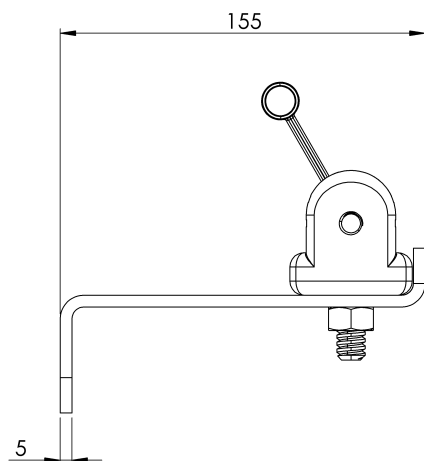
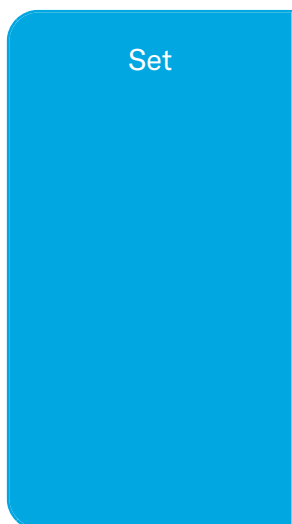

# CHO INTER

## Produto



## Descrição

- Componente da linha de vida CHECKLINE OVERHEAD
- A sua principal missão é ser o suporte intermédio do cabo.
- Podem ser colocados a uma distância máxima de 12 m um do outro.
- Foram especificamente concebidos de modo a que os OVERHEAD CARTS possam ultrapassar facilmente a peça, sem se desligarem da linha de vida.

## Padrão

EN 795 Tipo C

# CARACTERÍSTICAS

## Caraterísticas gerais

Referência	200701500030
Material	Aço inoxidável 304
Peso	1,15 kg
Dimensões	155x98 mm



# PLANOS

Conjunto

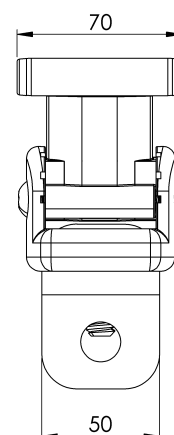
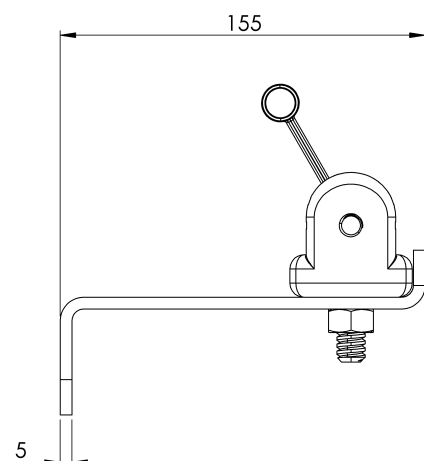

# CHO INTER

## Produit



## Description

- Composant de la ligne de vie CHECKLINE OVERHEAD
- Sa mission principale est d'être le support intermédiaire du câble.
- Ils peuvent être placés à une distance maximale de 12 mètres les uns des autres.
- Elles sont spécifiquement conçues pour que les chariots surplombants puissent facilement surmonter la pièce, sans se déconnecter de la ligne de vie.

## Standard

EN 795 Type C

# CARACTÉRISTIQUES

## Caractéristiques générales

Référence	200701500030
Matériel	Acier inoxydable 304
Poids	1,15 Kg
Dimensions	155x98 mm

# PLANS

Set (jeu de mots)

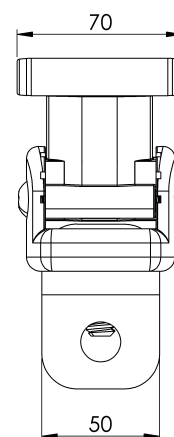
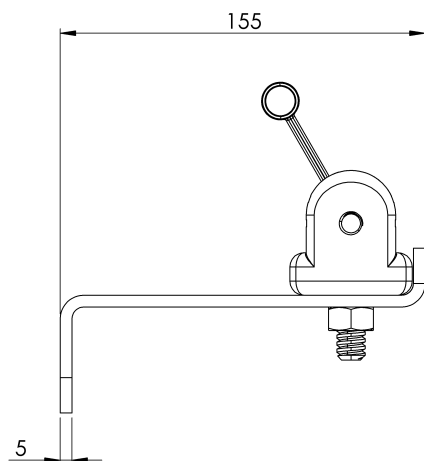

# CHO INTER

## Produkt



## Beschreibung

- Lifeline-Komponente CHECKLINE OVERHEAD
- Seine Hauptaufgabe besteht darin, als Zwischenstütze für das Kabel zu dienen.
- Sie können in einem maximalen Abstand von 12 m zueinander aufgestellt werden.
- Sie sind speziell so konstruiert, dass die OVERHEAD CARTS das Teil leicht überwinden können, ohne sich von der Rettungsleine zu lösen.

## Standard

EN 795 Typ C

# EIGENSCHAFTEN

## Allgemeine Merkmale

Referenz	200701500030
Material	Rostfreier Stahl 304
Gewicht	1,15 kg
Abmessungen	155x98 mm

# PLANEN

Einstellung

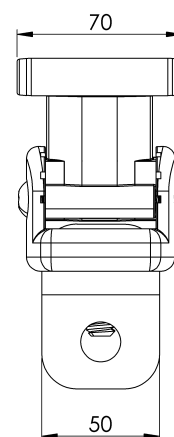
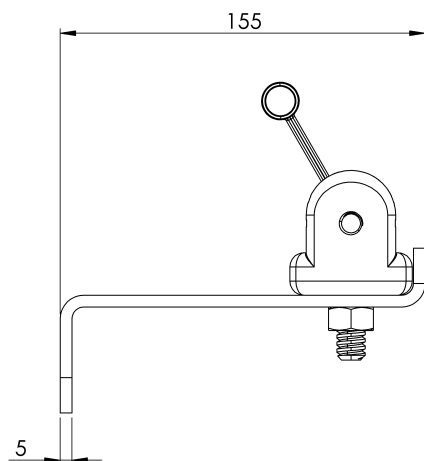

# CHO INTER

## Produkt



## Opis

- Element linii życia CHECKLINE OVERHEAD
- Jego głównym zadaniem jest pośrednie wsparcie dla kabla.
- Można je umieścić w maksymalnej odległości 12 m od siebie.
- Zostały one specjalnie zaprojektowane tak, aby wózki OVERHEAD CARTS mogły z łatwością pokonać tę część bez odłączania się od linii życia.

## Standard

EN 795 Typ C

# CHARAKTERYSTYKA

## Ogólna charakterystyka

Odniesienie	200701500030
Material	Stal nierdzewna 304
Waga	1,15 kg
Wymiary	155x98 mm

# PLANY

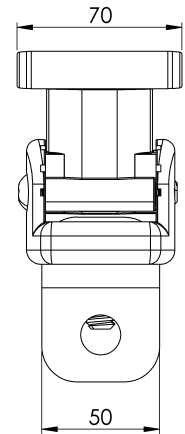
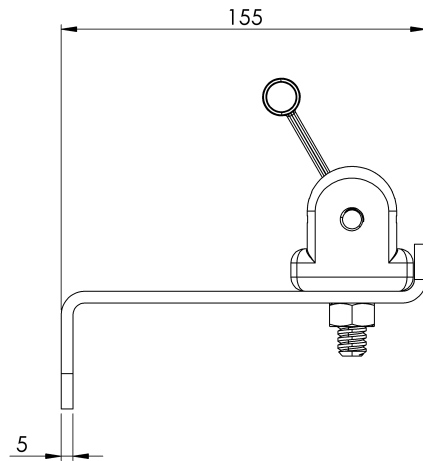
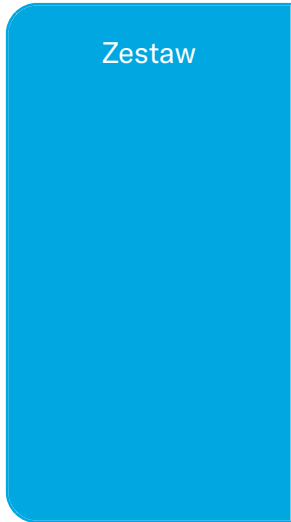

# CHO INTER

## Termék

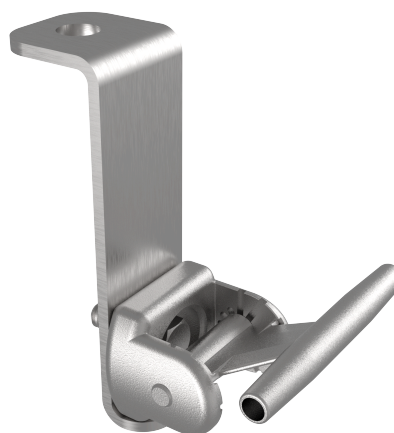

## Leírás

- Életvonal-összetevő CHECKLINE OVERHEAD
- Fő feladata, hogy a kábel köztes támasza legyen.
- Egymástól legfeljebb 12 m távolságra helyezhető el.
- Ezeket kifejezetten úgy tervezték, hogy az OVERHEAD CARTS könnyedén leküzdhesse az alkatrészt anélkül, hogy a mentőkötélről leválna.

## Standard

EN 795 C típus

# JELLEMZŐK

Általános jellemzők	Hivatkozás	200701500030
	Anyag	304 rozsdamentes acél
	Súly	1,15 kg
	Méret	155x98 mm



## TERVEK

Állítsa be a

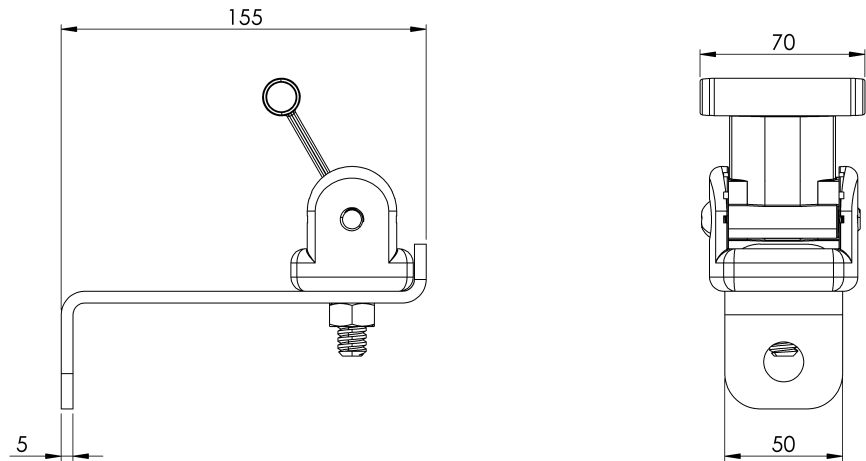

# CHO INTER

## Produto



## Descrição

- Componente da linha de vida CHECKLINE OVERHEAD
- Sua principal missão é ser o suporte intermediário para o cabo.
- Ele pode ser colocado a uma distância máxima de 12 m um do outro.
- Eles foram projetados especificamente para que os OVERHEAD CARTS pudessem superar facilmente a peça, sem se desconectar da linha de vida.

## Padrão

EN 795 Tipo C

# CARACTERÍSTICAS

## Características gerais

Referência	200701500030
Material	Aço inoxidável 304
Peso	1,15 kg
Dimensões	155x98 mm

# PLANOS

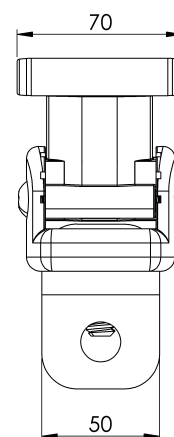
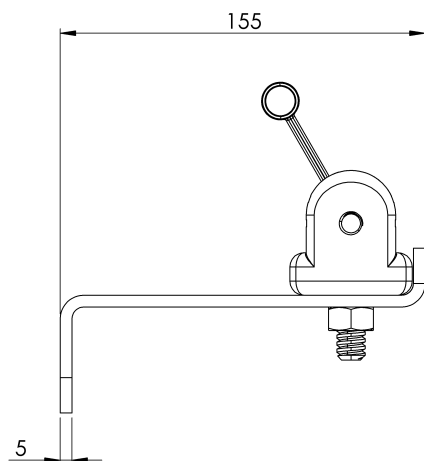
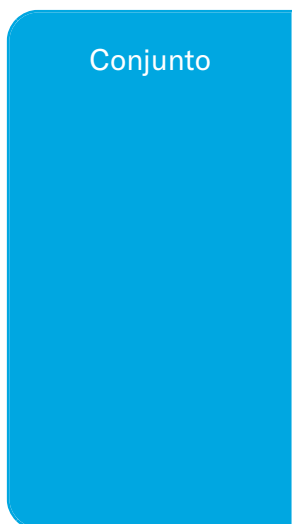

# CHO INTER

## Продукт



## Описание

- Компонент на спасителната линия CHECKLINE OVERHEAD
- Основната му задача е да бъде междинна опора на кабела.
- Той може да бъде поставен на максимално разстояние 12 м един от друг.
- Те са специално проектирани така, че количките с надстройка да могат лесно да преодолеят частта, без да се откъсват от спасителната линия.

## Стандартен

EN 795 Тип C

# ХАРАКТЕРИСТИКИ

## Общи характеристики

Справка	200701500030
Материал	304 неръждаема стомана
Тегло	1,15 кг
Размери	155x98 мм

# ПЛАНОВЕ

Задайте

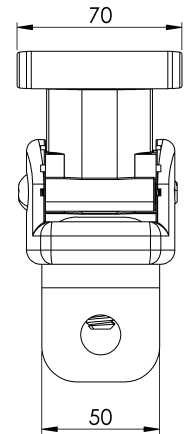
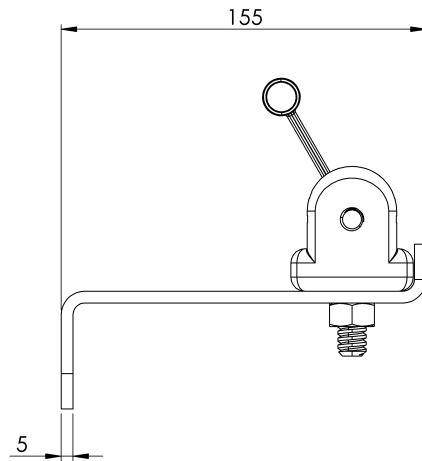

# CHO INTER

## Produkt



## Beskrivning

- Lifeline-komponent CHECKLINE OVERHEAD
- Dess huvuduppgift är att vara det mellanliggande stödet för kabeln.
- Den kan placeras på ett maximalt avstånd av 12 meter från varandra.
- De är särskilt utformade så att OVERHEAD CARTS lätt kan övervinna delen utan att koppla loss sig från livlinan.

## Standard

EN 795 Typ C

# EGENSKAPER

## Allmänna egenskaper

Reference (referens)	200701500030
Material	304 rostfritt stål
Vikt	1,15 kg
Dimensioner	155x98 mm

# PLANER

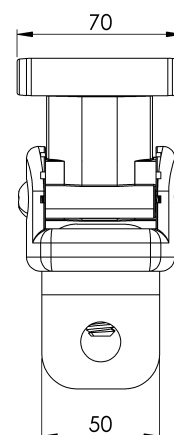
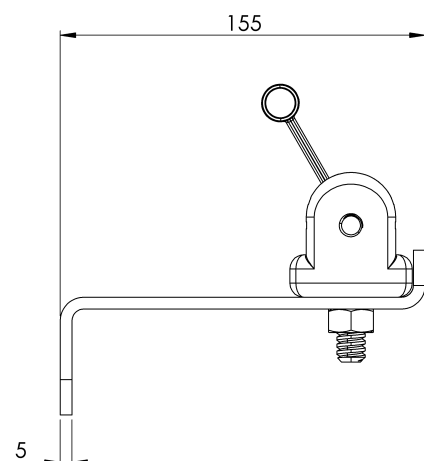
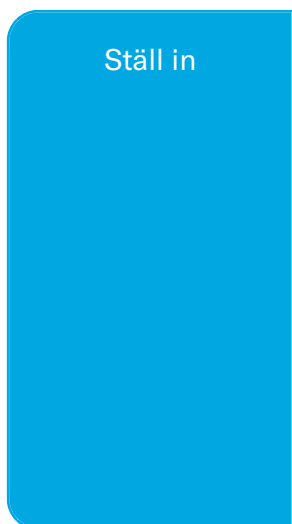

# CHO INTER

## Produkt



## Popis

- Komponent Lifeline CHECKLINE OVERHEAD
- Jeho hlavným poslaním je byť medziľahlou podporou pre kábel.
- Môže byť umiestnený v maximálnej vzdialenosti 12 m od seba.
- Sú špeciálne navrhnuté tak, aby vozíky OVERHEAD CARTS mohli ľahko prekonať časť bez toho, aby sa odpojili od záchranného lana.

## Štandard

EN 795 Typ C

# CHARAKTERISTIKA

## Všeobecná charakteristika

Referencia	200701500030
Materiál	304 nehrdzavejúca oceľ
Hmotnosť	1,15 kg
Rozmery	155x98 mm



# PLÁNY

Nastavenie

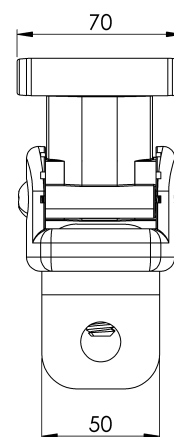
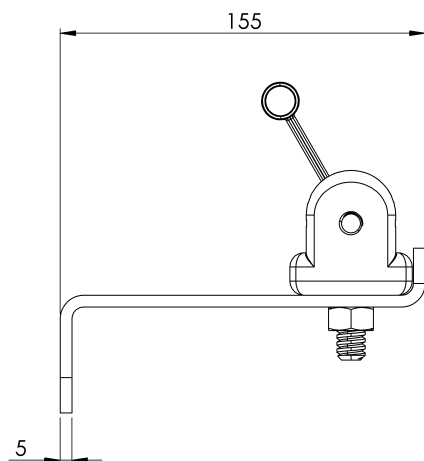

# CHO INTER

## Produktas



## Aprašymas

- Gelbėjimo linijos komponentas CHECKLINE OVERHEAD
- Pagrindinė jo užduotis - būti tarpine kabelio atrama.
- Juos galima statyti ne didesniu kaip 12 m atstumu vieną nuo kito.
- Jie specialiai suprojektuoti taip, kad viršugalvio vežimėliai galėtų lengvai įveikti šią dalį, neatjungdami jos nuo gelbėjimo virvės.

## Standartinis

EN 795 C tipas

# CHARAKTERISTIKOS

## Bendrosios charakteristikos

Nurodymai	200701500030
Medžiaga	304 nerūdijantis plienas
Svoris	1,15 kg
Matmenys	155x98 mm

# PLANAI

Nustatyti

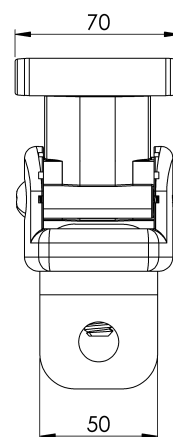
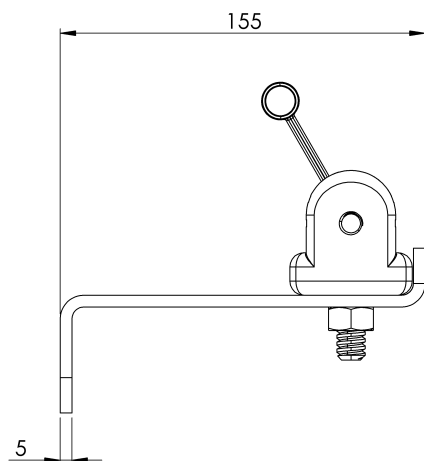

# CHO INTER

## Produkt



## Beskrivelse

- Lifeline-komponent CHECKLINE OVERHEAD
- Hovedoppgaven er å være mellomstøtte for kabelen.
- Den kan plasseres med en maksimal avstand på 12 meter fra hverandre.
- De er spesielt utformet slik at OVERHEAD CARTS enkelt kan overvinne delen uten å koble seg fra livlinen.

## Standard

EN 795 Type C

# EGENSKAPER

## Generelle egenskaper

Referanse	200701500030
Materiale	304 rustfritt stål
Vekt	1,15 kg
Dimensjoner	155x98 mm

# PLANER

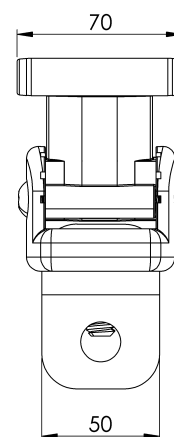
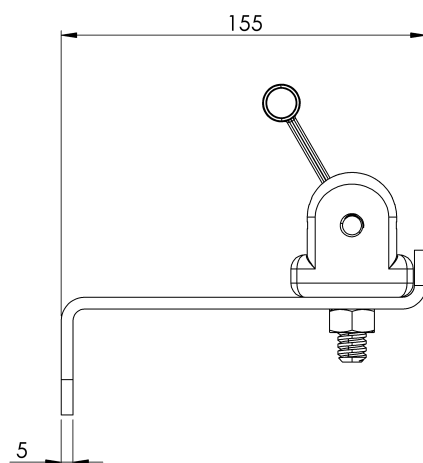
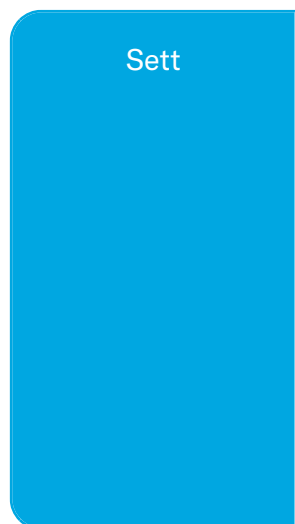

# CHO INTER

## Produs



## Descriere

- Componenta Lifeline CHECKLINE OVERHEAD
- Principala sa misiune este de a fi suportul intermediar pentru cablu.
- Acestea pot fi amplasate la o distanță maximă de 12 m una de cealaltă.
- Acestea sunt proiectate special astfel încât cărucioarele supraetajate să poată depăși cu ușurință partea, fără a se deconecta de la linia de salvare.

## Standard

EN 795 Tip C

# CARACTERISTICI

## Caracteristici generale

Referință	200701500030
Material	304 oțel inoxidabil
Greutate	1,15 Kg
Dimensiuni	155x98 mm

# PLANURI

